

# Soils Map

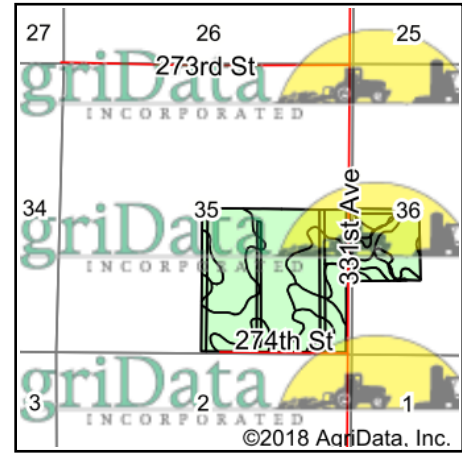

State: **South Dakota**  
 County: **Tripp**  
 Location: **35-100N-74W**  
 Township: **Bull Creek**  
 Acres: **196.7**  
 Date: **11/28/2018**

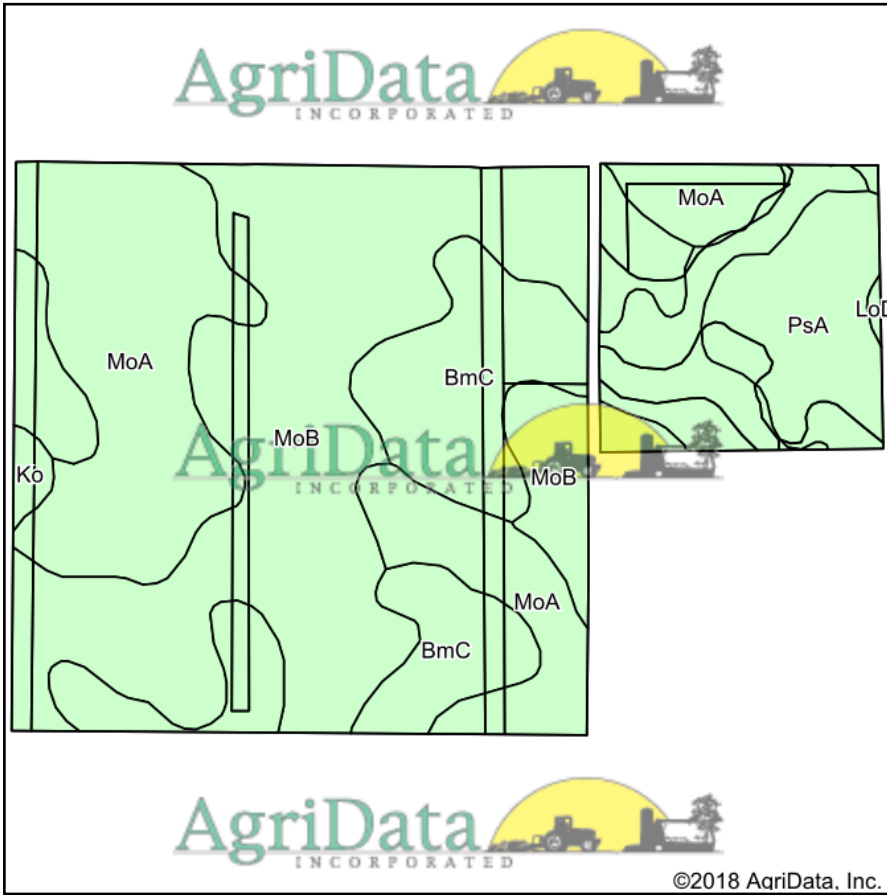

Soils data provided by USDA and NRCS.

**Area Symbol: SD123, Soil Area Version: 19**

Code	Soil Description	Acres	Percent of field	Non-Irr Class *c	Irr Class *c	Productivity Index	Tall wheatgrass	*n NCCPI Soybeans
MoB	Millboro silty clay, 3 to 6 percent slopes	83.05	42.2%	IIIe	IIIe	79		28
MoA	Millboro silty clay, 0 to 3 percent slopes	57.58	29.3%	IIs	IIs	86		32
BmC	Boro-Millboro silty clays, 6 to 9 percent slopes	38.24	19.4%	IVe	IVe	56		31
PsA	Wendte clay, channeled, 0 to 2 percent slopes	16.15	8.2%	VIw		34	2.5	18
Ko	Kolls clay	1.38	0.7%	Vw	Vw	30		3
LoD	Lakoma-Okaton silty clays, 6 to 15 percent slopes	0.30	0.2%	IVe	IVe	33		17
<b>Weighted Average</b>						<b>72.5</b>	<b>0.2</b>	<b>*n 28.7</b>

\*n: The aggregation method is "Weighted Average using major components"

\*c: Using Capabilities Class Dominant Condition Aggregation Method

Soils data provided by USDA and NRCS.